

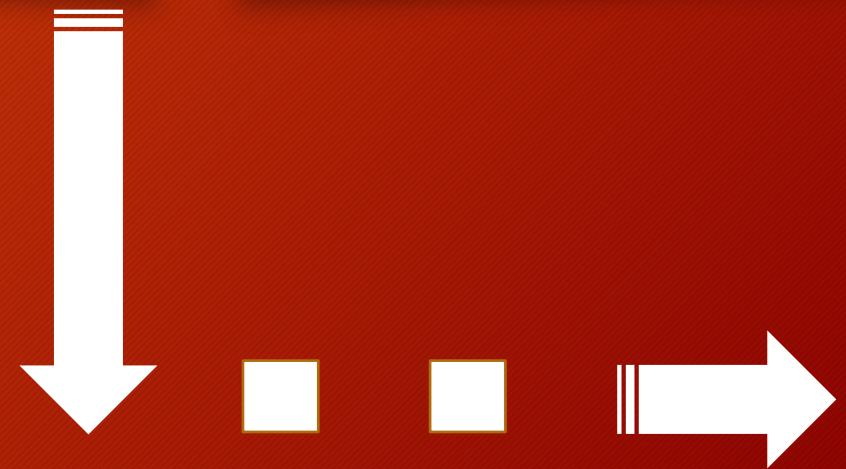

Having an Escape Plan

Exit Drills In The Home (EDITH)



PLAN AHEAD!

- If a fire breaks out in your home, you may have only a few minutes to get out safely once the smoke alarm sounds. Everyone needs to know what to do and where to go if there is a fire.



Making a Home Escape Plan

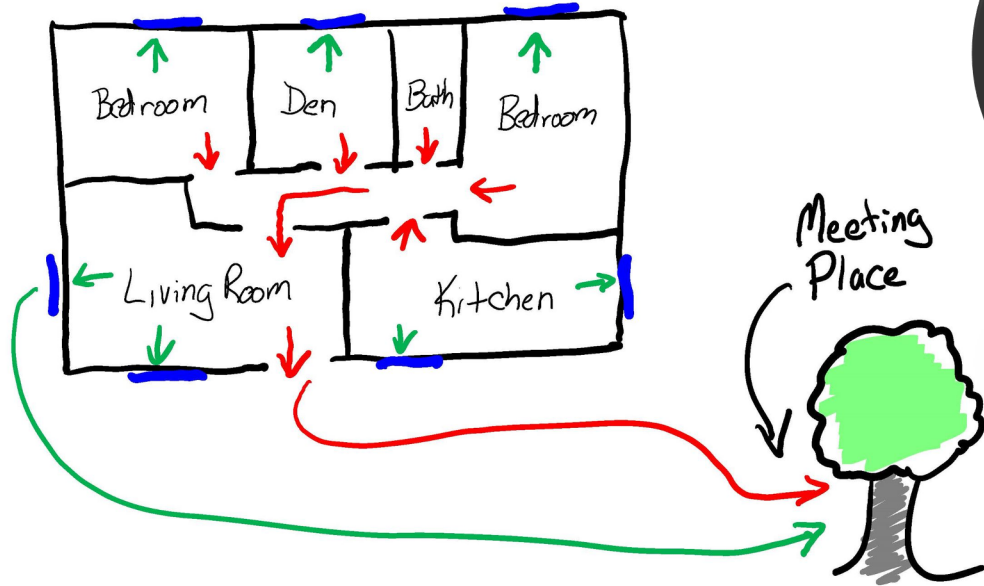
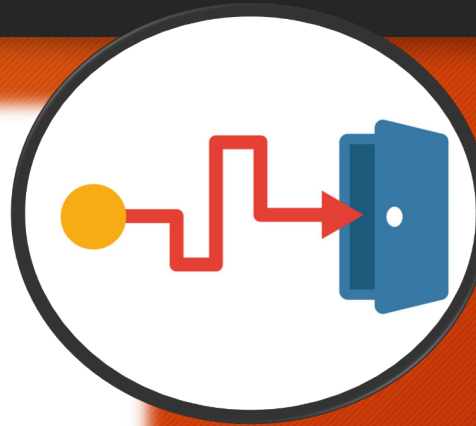

- Draw a map of your home showing all doors and windows. Discuss the plan with everyone in your home.

Have TWO ways out!



- Know at least two ways out of every room if possible. Inspect your doors and windows to ensure they operate easily.

Have an Outside Meeting Place

- Select a location that is a safe distance away from the home like a mailbox, a light post, or a tree where everyone should meet once outside. Make sure once you're out, you **STAY** out.



PRACTICE, PRACTICE, PRACTICE



Practice your exit drills twice a year during the day and at night.

Practice using different ways out

Teach children how to escape on their own in case you can't help them.

Close doors behind you as you leave

When the Smoke Alarm Sounds....

- Get out and **STAY** out. **NEVER** go back in for people or pets.
- If you're escaping through the smoke, **STAY LOW!** Crawl under the smoke until you are outside.
- Call the fire department when you are outside.



When the Smoke Alarm Sounds....

- If there are infants, older adults, or family members with mobility limitations, make sure that someone is assigned to assist them in the fire drill and in the event of an emergency. Assign a backup person too, in case the designee is not home during the emergency



FACTS



- If windows or doors in your home have security bars, make sure that the bars have emergency release devices inside so that they can be opened immediately in an emergency. Emergency release devices won't compromise your security - but they will increase your chances of safely escaping a home fire.

FACTS



- A closed door may slow the spread of smoke, heat, and fire. Install smoke alarms inside every sleeping room and outside each separate sleeping area. Install alarms on every level of the home. Smoke alarms should be interconnected. When one smoke alarm sounds, they all sound.

FACTS

- According to an NFPA survey, only one of every three American households have actually developed and practiced a home fire escape plan.

